



MAKE EVERYTHING EASIER





MANUAL STACKER





Forged Forks

SDJA500

SDJA1000

SDJA1500

- With adjustable forks between 200-950mm.
- Lifting Height from 1600mm to 2500mm.
- High quality steel mast ensures rigidity and durability.
- Adjustable forged forks.
- High effort pumps makes the control easier to operate.
- Foot and hand controlled lifting function allows the operator to work without having to perform extreme body movements.
- Metal grid protects user from lifting chains.
- With safety wheel guard and brake system to ensure safety during operation.

| Model | | SDJA500 | SDJA1000 | SDJA1500 |
|---------------------------------------------|---------------|------------------|------------------|------------------|
| Load capacity/rated load | Q(kg) | 500 | 1000 | 1500 |
| Load centre distance | c(mm) | 500 | 500 | 500 |
| Fork height, lowered | h_{13} (mm) | 90 | 90 | 90 |
| Height, mast lowered | h_1 (mm) | 2000 | 2085/1840 | 2090 |
| Max. lift height | h_3 (mm) | 1600 | 1600/2500 | 1600 |
| Height, mast extended | h_4 (mm) | 2010 | 2165/2925 | 2150 |
| Overall length | l_1 (mm) | 1380/1640 | 1380/1640 | 1380/1640 |
| Overall width | b_1 (mm) | 805 | 1000/750 | 1000 |
| Fork dimensions | s/e/l(mm) | 48/100/800(1060) | 30/100/800(1060) | 30/100/800(1060) |
| Width overall forks | b_5 (mm) | 200-745 | 200-950/700 | 200-950 |
| Ground clearance, laden, below mast | m_1 (mm) | 20 | 25 | 25 |
| Aisle width for pallets 1000x1200 crossways | A_{st} (mm) | 1915 | 1915 | 1915 |
| Aisle width for pallets 800x1200 lengthways | A_{st} (mm) | 1910 | - | - |
| Turning radius | W_a (mm) | 1235 | 1235 | 1235 |
| Lift speed,laden/unladen | mm/time | 25 | 25 | 21 |
| Lowering speed,laden/unladen | mm/s | Manual control | Manual control | Manual control |
| Service weight | kg | 161 | 250/316 | 280 |

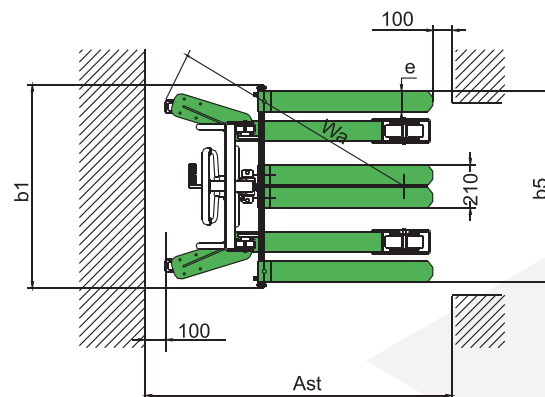
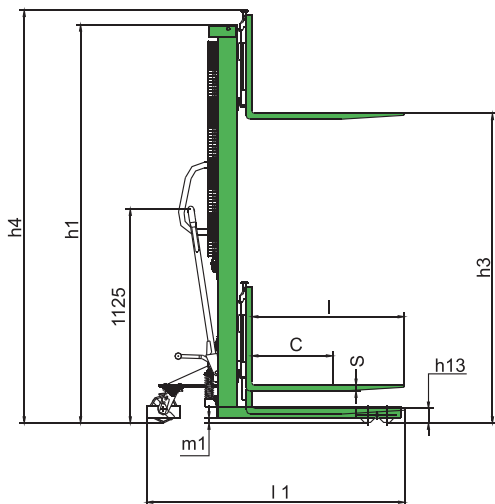



SDJAS500

SDJAS1000

- Straddle legs width reach 1300mm(500kg)and1250mm(1000kgs).
- Lifting Height from 1500-1600mm.
- With adjustable forged forks.
- High quality steel mast ensures rigidity and durability.
- High efficient pumps makes the control easier to operate.
- Foot and hand controlled lifting function allows the operator to work without having to perform extreme body movements.
- Metal grid protects user from lift chains.
- With safety wheel guard and brake system to ensure safety during operation.

| Model | | SDJAS500 | SDJAS1000 |
|---------------------------------------------|---------------|------------------|------------------|
| Load capacity/rated load | Q(kg) | 500 | 1000 |
| Load centre distance | c(mm) | 500 | 500 |
| Fork height, lowered | h_{13} (mm) | 70 | 70 |
| Height, mast lowered | h_1 (mm) | 2000 | 2050 |
| Max. lift height | h_3 (mm) | 1600 | 1600 |
| Height, mast extended | h_4 (mm) | 2100 | 2155 |
| Overall length | l_1 (mm) | 1340/1600 | 1300/1560 |
| Overall width | b_1 (mm) | 1525 | 1475 |
| Fork dimensions | s/e/l(mm) | 48/100/800(1060) | 30/100/800(1060) |
| Width overall forks | b_5 (mm) | 745 | 950 |
| Round clearance, laden,below mast | m_1 (mm) | 25 | 25 |
| Aisle width for pallets 000x1200 crossways | A_{st} (mm) | 1975 | 1975 |
| Aisle width for pallets 800x1200 lengthways | A_{st} (mm) | 1915 | 1915 |
| Turning radius | W_a (mm) | 1200 | 1200 |
| Lift speed,laden/unladen | mm/time | 25 | 25 |
| Lowering speed,laden/unladen | mm/s | Manual control | Manual control |
| Service weight | kg | 223 | 294 |

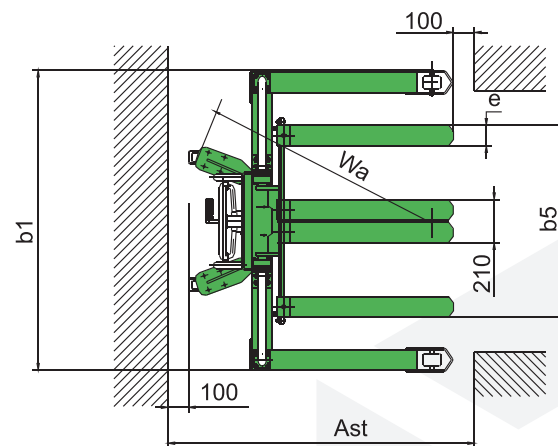
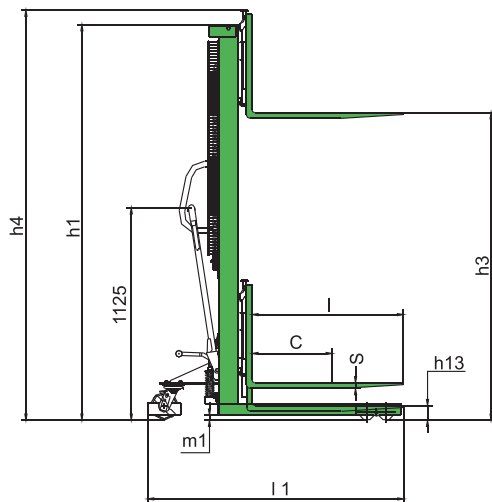



TEL: 0086-532-66739792

FAX: 0086-532-66739791

info@movmes.com

NO.88 Chunyang Road,Chengyang,
QINGDAO,CHINA

www.movmes.com